

CHICKEN COOP

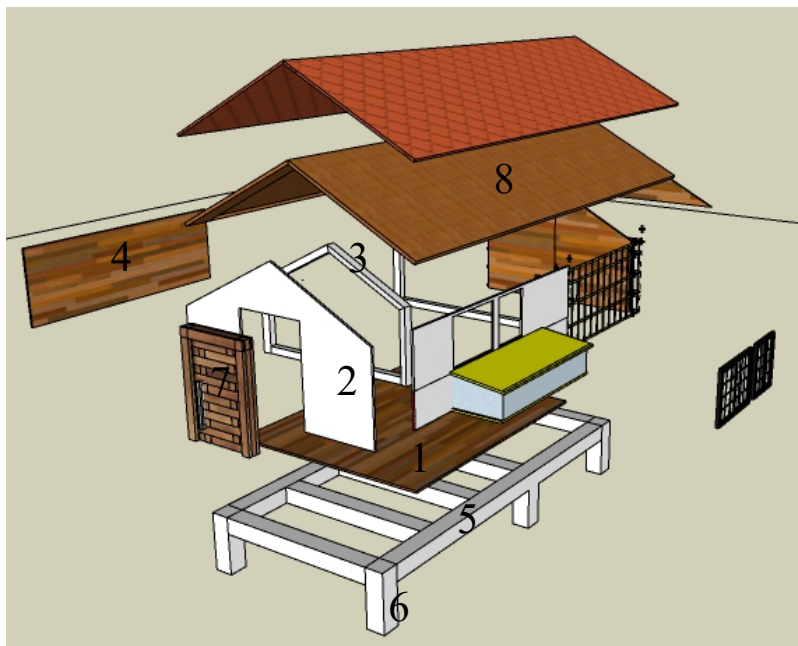

#	Name
1	Floor
2	Walls
3	Frame & Wall
4	Nesting Wall
5	Supports
6	Legs
7	Door
8	Hinges
9	Roof Supports

Step 1: To build the floor, simply frame up with 8'x9'-9" as shown below, using the 3" wood screws or nails.

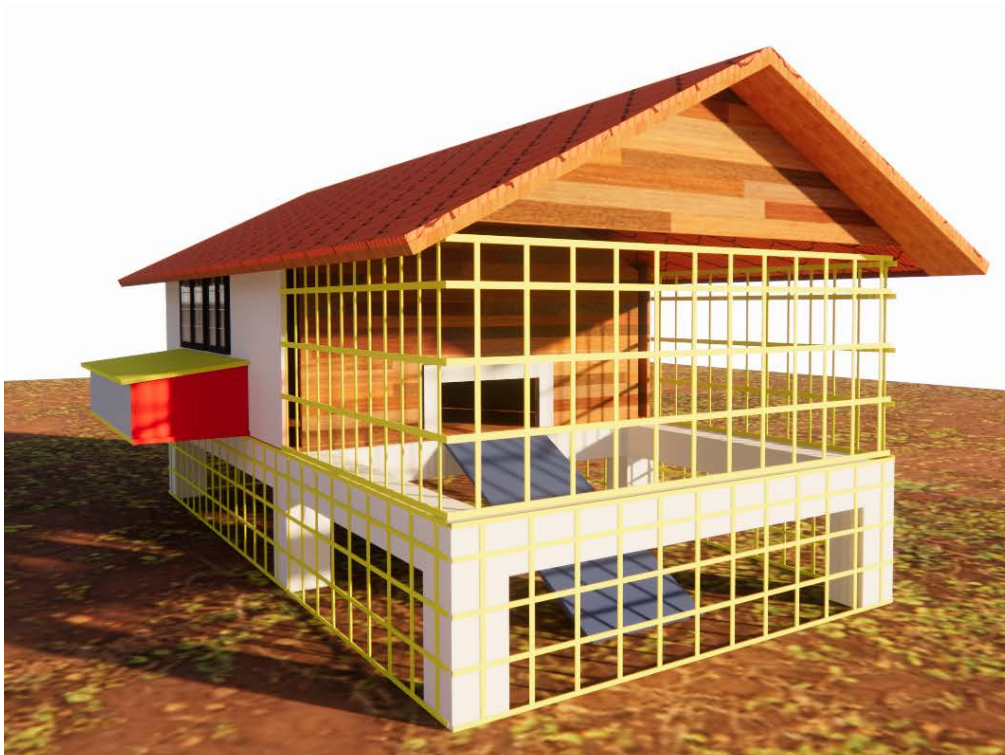
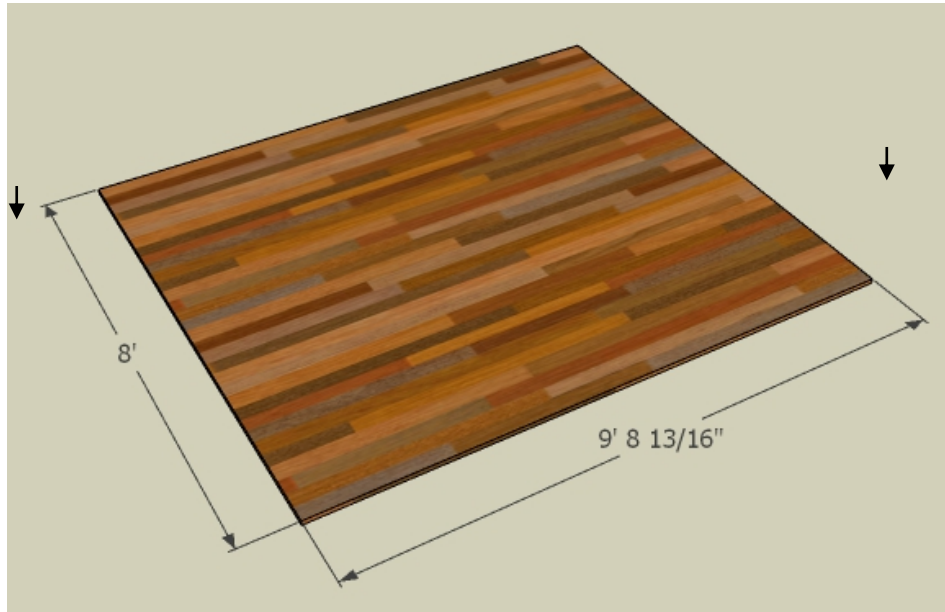

Step 2: You will need to frame two side walls.

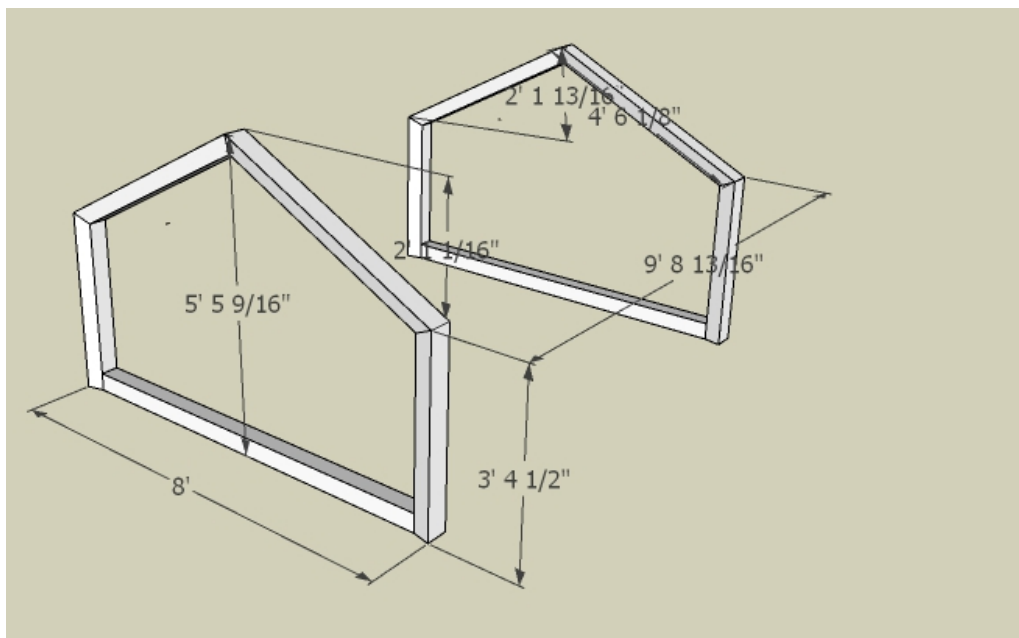

Step 3: Prepare Bottom Support as shown in Picture and Attach the wall and frame to the Base.

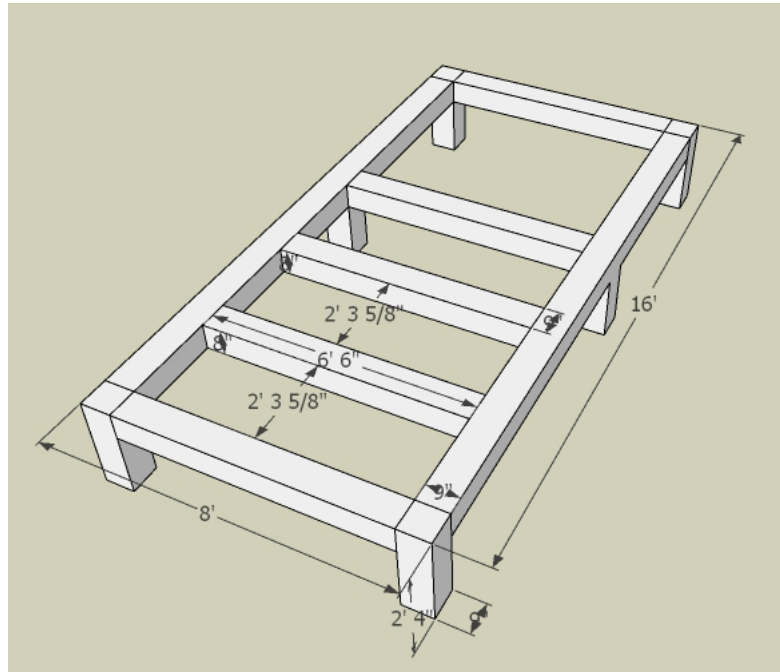

Step 4: Use 2x4s to attach the Nest wall and the supports.

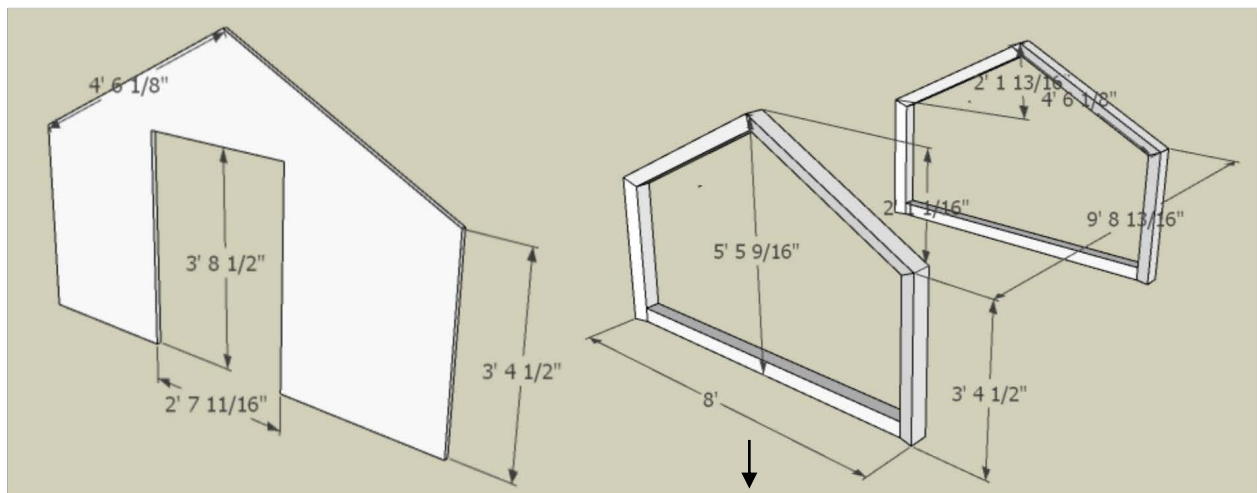

Step 5: Use 2x6s for the roof.

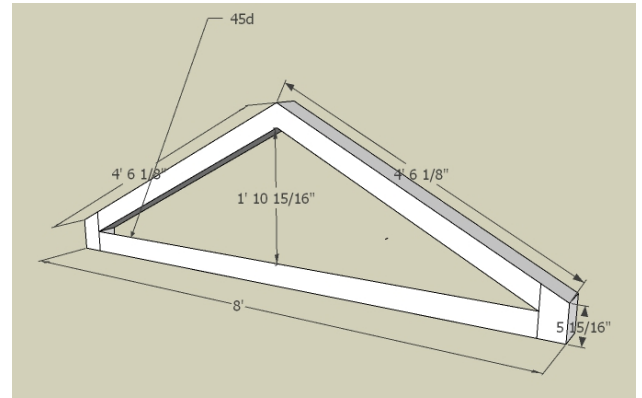
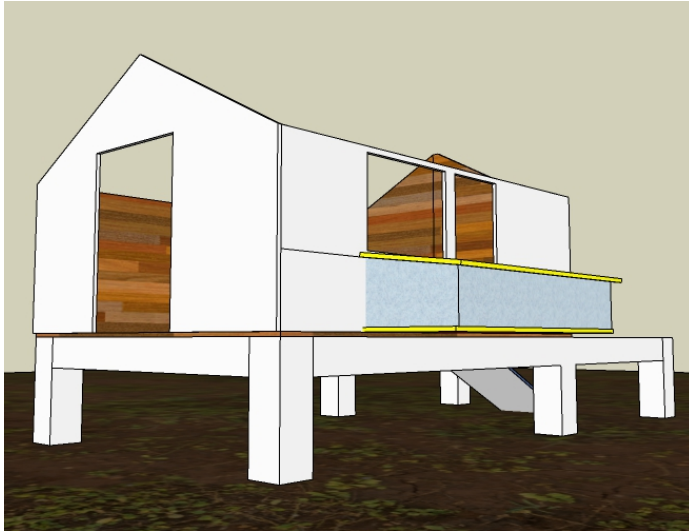

Step 6: Cover with triplay the walls and roof.

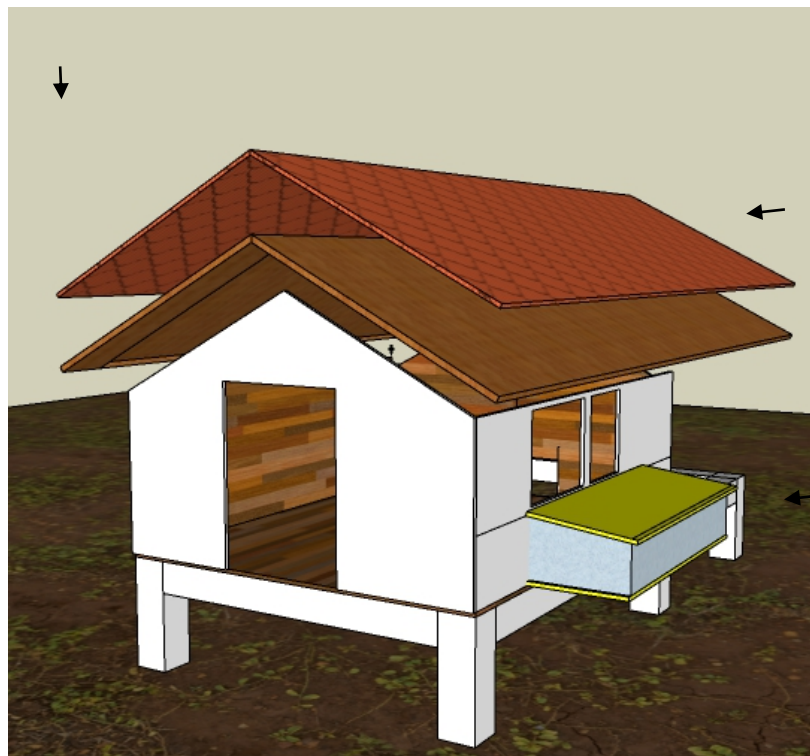

Step 7: provide pop door 12"x24" and attach plywood inclined to the ground.

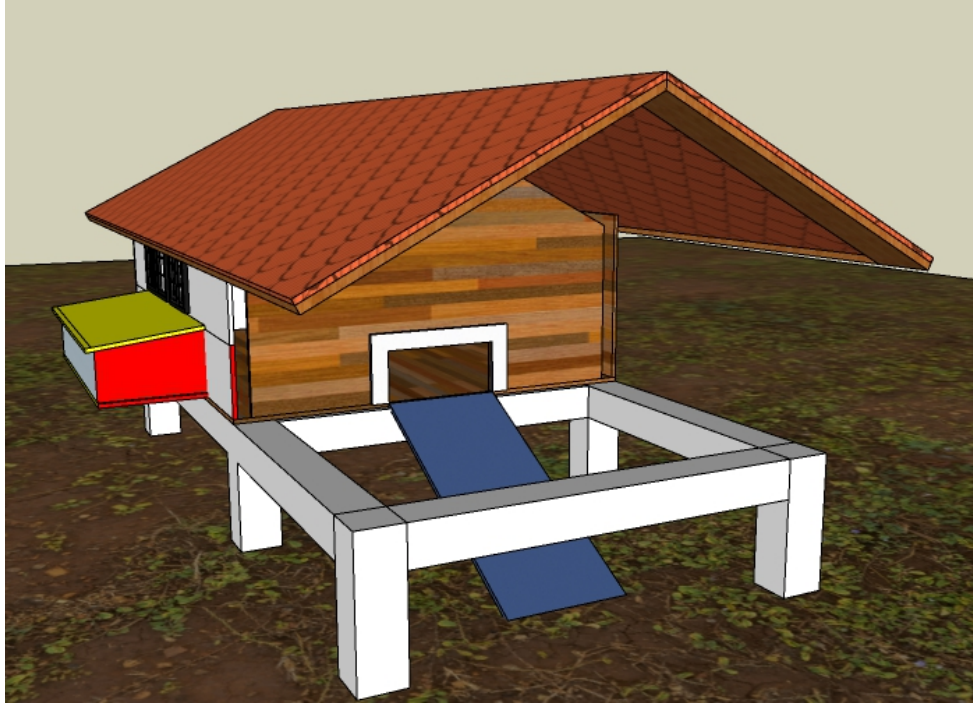

Step 8: Use Strap hinges to attach the door.

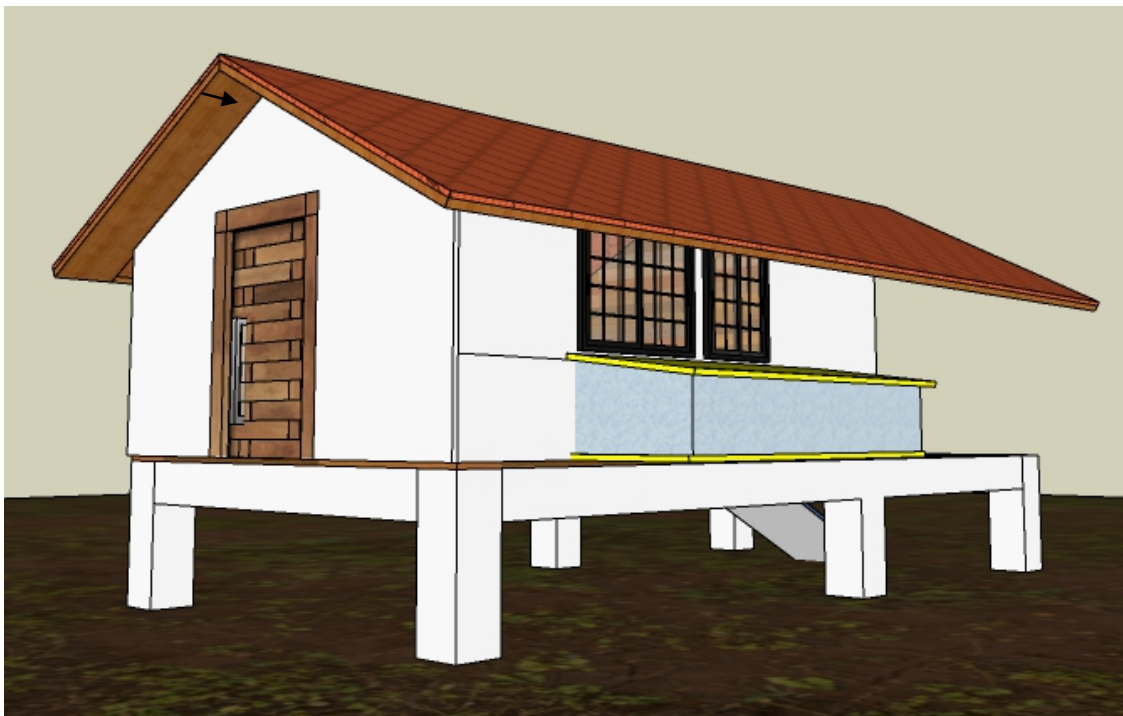

Step 9: Finally, place the exterior trims and the chicken wire in the lower part.

